



Bi-Sonic



## DC 4028-02

**SIZE:**

40mm×40mm×28mm(1.57"×1.57"×1.1")

**CONSTRUCTION:**

Glass fiber reinforced plastic: Impeller and housing PBT are UL 94V-0 rating

**DIELECTRIC STRENGTH:**

5mA max. at 500VAC 60Hz one minute (between frame and terminal)

**INSULATION RESISTANCE**

10mega Ohm min.at 500 VDC (between frame and terminal)

**OPERATING TEMPERATURE:**

Ball bearing: -10°C to +75°C

**FUNCTION(Optional):**

Polarity Protection/Auto Restart/ FG or RD/PWM/IP68

**WEIGHT:**

40 grams

### Specifications:

MODEL NO.	BEARING	RATED	OPERATING	MAX.	MAX.	SPEED	MAX. AIR FLOW		MAX. AIR		NOISE
		VOLTAGE	VOLTAGE	CURRENT	INPUT		m3/min	CFM	mmH2O	inH2O	
		VDC	V	A	W	R.P.M.					
BP402824M-02	Ball	24	12~27.6	0.2	4.8	10000	0.40	14.2	12.3	0.484	45.75
BP402824H-02	Ball	24	12~27.6	0.46	11.04	17000	0.70	24.6	30.5	1.201	57.3

Dimensions (mm)

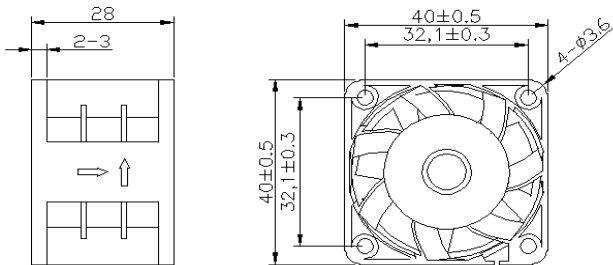

Performance Curve

